

115 Coupler

Part Number	Connection Type	A Overall Length	H Hex Size	Maximum Working Pressure
#				
		inch	inch	psi
C10-115-1202	1/4" BSP Female (thru type)	2.30	0.94	14,500
C10-115-1222	1/4" BSP Female (with built-in locking device)	2.30	0.94	14,500
C10-115-1401	1/8" NPT Female	2.30	0.94	14,500
C10-115-1402	1/4" NPT Female	2.30	0.94	14,500
C10-115-1404	3/8" NPT Female	2.38	0.94	14,500
C10-115-1422	1/4" NPT Female (with built-in locking device)	2.30	0.94	14,500
C10-115-1452	1/4" NPT Male	2.45	0.94	14,500
C10-115-1454	3/8" NPT Male	2.45	0.94	14,500

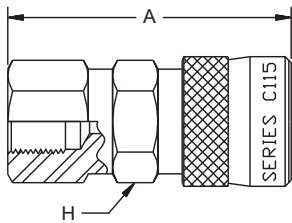

C10-115-1202

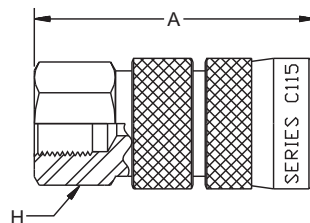

C10-115-1222

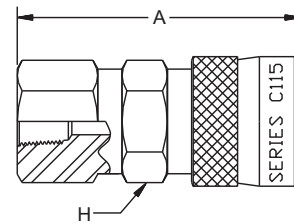

C10-115-1401

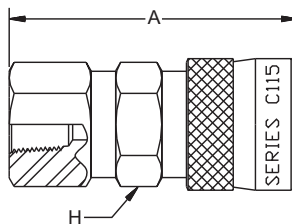

C10-115-1402

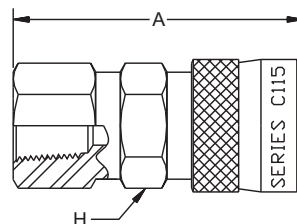

C10-115-1404

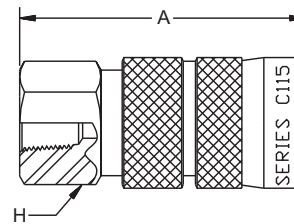

C10-115-1422

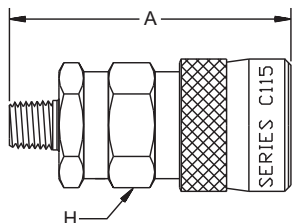

C10-115-1452

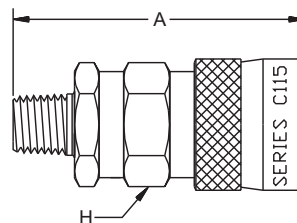

C10-115-1454